

RESTRINGING
GUIDE

MG901
LAP HARP

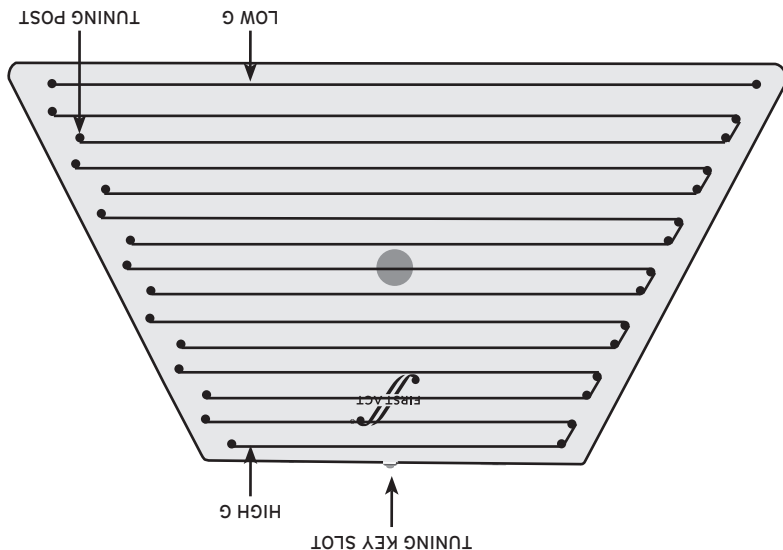

First Act Inc.
745 Boylston Street
Boston, MA 02116 USA
firstact.com

Customer Assistance
Phone: 888.551.1115
Email: info@firstact.com

First Act and the First Act logo are trademarks of First Act Inc.
©2008 First Act Inc.
All rights reserved.
MG901.M.03

RESTRINGING YOUR LAP HARP

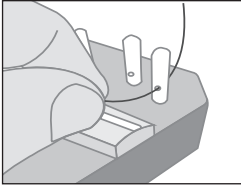

Figure 1

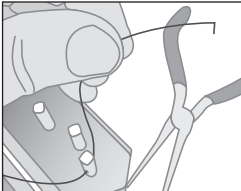

Figure 2

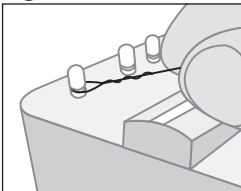

Figure 3

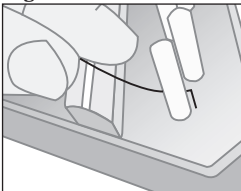

Figure 4

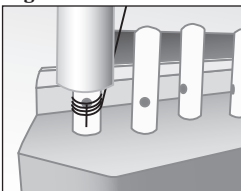

Figure 5

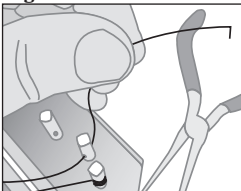

Figure 6

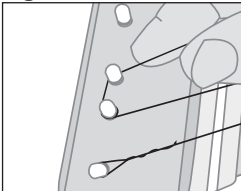

Figure 7

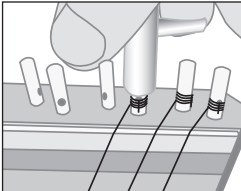

Figure 8

1. To change the “Low G” or bottom string, use the extra G string included in this package. For all other strings, refer to step #10.
2. Run the end of the string (the end that does not have a loop) through the hole in the tuning post on the right hand side of the harp (Fig. 1).
3. Measuring 1/8 inch from the end of the string, bend it at a right angle with a pair of pliers. (Fig. 2)
Be careful of the sharp point at the end of the string!
4. Put the looped end of the “G” string around the corresponding anchor post on the left hand side of the harp. (Fig. 3)
5. Pull the string so that the bent section at the end is resting flat against the tuning post.
6. Make sure the end is pointing towards the ground. (Fig. 4)
7. Use your left hand and pull lightly on the string to create tension. At the same time, use your right hand to turn the tuning post with the tuning key in a clockwise motion.
8. As you turn, be sure the string wraps OVER the bent end. This will prevent the string from slipping out of the eyelet. (Fig. 5)
9. Do not make it too tight, as too much tension will break the string.

Refer to the enclosed tuning instructions to tune the string.

10. For all other strings:
Run the string through the tuning post and bend the end with the pliers. (Fig. 6)
Be careful of the sharp point at the end of the string!
11. Turn the tuning post with the tuning key* until you have four loops around the post.
12. Run the string against the corresponding anchor post and make one loop. (Fig. 7)
13. Run the string around the next anchor post while maintaining tension (no loop this time).
14. Bring the loose end of the string back to the other side of the harp.
15. Run it through the eyelet of the next available tuning post.
16. Bend the end with the pliers and turn the tuning post until moderately tight. (Fig. 8)
17. Refer to the enclosed tuning instructions to tune the string.

*The tuning key is stored in a covered slot at the top of the lap harp.